

THE INFORMATION CONTAINED IN THIS DRAWING IS THE SOLE PROPERTY OF RADIAN HEATSINKS AND ANY REPRODUCTION IN PART OR IN WHOLE IS STRICTLY PROHIBITED WITHOUT THE WRITTEN PERMISSION OF RADIAN HEATSINKS.

REV	DESCRIPTION	DRAWN	APPROVED	DATE
A	INITIAL RELEASE	JP	KP	4/21/2020

TABLE 1		
PLEASE NOTE: BASE THICKNESS CAN BE MODIFIED TO ANY THICKNESS BETWEEN 1 TO 2.5 TO ACCOMMODATE PRACTICALLY ANY CHIP SIZE. CHIP SIZE DOES NOT INCLUDE SOLDER BALLS HEIGHT.		
CLIP COLORS	MIN - MAX CHIP THICKNESS	
(O) ORANGE	3.2 - 3.8 MM	
(B) BLUE	4.0 - 4.6 MM	
(Y) YELLOW	5.6 - 6.2 MM	
EXAMPLE PART NUMBERS		
PART NUMBER	DESCRIPTION	CHIP THICKNESS RANGE
FB47.5/2.2+Y+T725	MODIFIED BASE THICKNESS TO 2.2MM. HAS A YELLOW CLIP AND T725 TIM	3.3 - 3.9 MM
FB47.5+3M8815	HEATSINK AND FAN WITH 3M8815 THERMAL TAPE. NO CLIP REQUIRED.	ANY CHIP SIZE

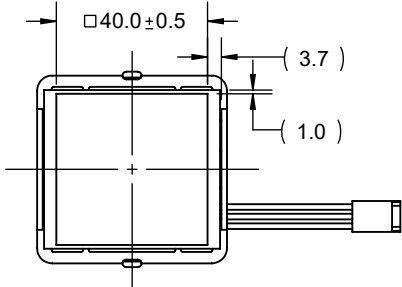
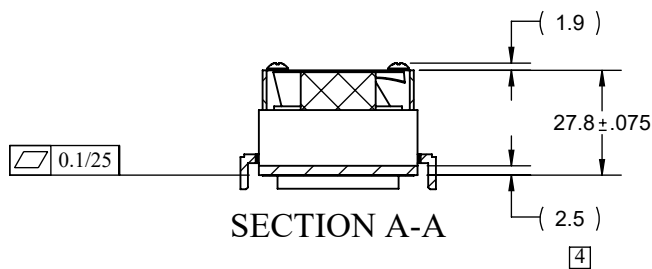
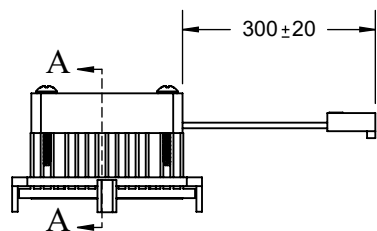
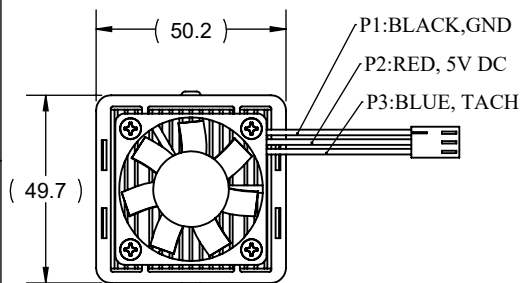

NOTES:

1. CUSTOMER TO SPECIFY COMPLETE PART NUMBER. SEE "EXAMPLE PART NUMBERS" TABLE FOR PART NUMBER CONVENTIONS.
2. IF BASE THICKNESS IS MODIFIED, RE-ANODIZATION NOT REQUIRED.
3. FAN AND SCREWS ARE SHOWN FOR ILLUSTRATION PURPOSE ONLY, ACTUAL PARTS MAY LOOK DIFFERENT.
4. DEFAULT BASE THICKNESS. IF MODIFICATION IS REQUIRED, CANNOT BE REDUCED TO LESS THAN 1MM.
5. PART TO BE RoHS COMPLIANT.

EXPLODED VIEW

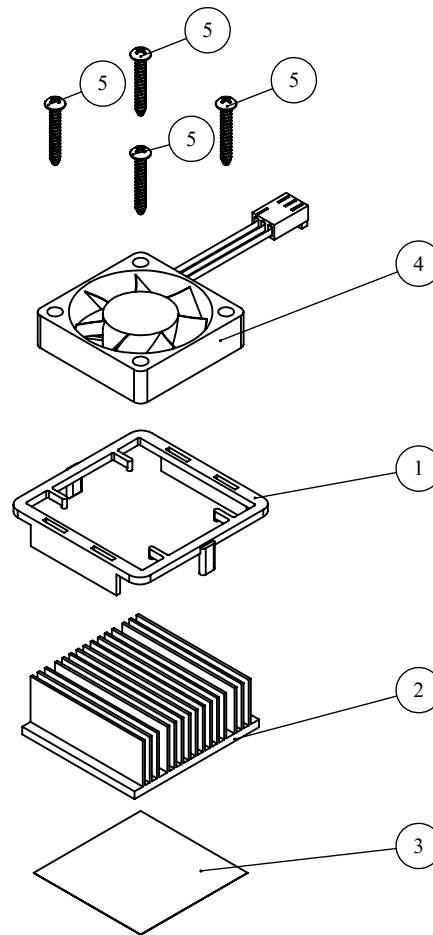

ITEM NO.	PART NUMBER	DESCRIPTION	QTY.
1	BCP50-09(47.5)COLOR	EZ SNAP CLIP, 47.5 mm BGA	1
2	HS10000	HEATSINK, PLATE FIN, 42 X 46.6 X 17.25 mm	1
3	Optional	TIM PAD 40X40 MM OR FULL COVERAGE	1
4	HS8074	40X40X10MM 5V FAN WITH CONNECTOR	1
5	4N75PPBZB	#4 X 3/4 PHIL PAN TYPE B SMS BLK (RoHS) OR EQUIVALENT	4

UNLESS OTHERWISE SPECIFIED DIMENSIONS ARE IN MM  
TOLERANCES ARE:  
1 PLACE DECIMALS: ± 0.25  
2 PLACE DECIMALS: ± 0.10  
ANGLES: ± 1°

THIRD ANGLE PROJECTION

APPROVALS	DATE
DRAWN JPOLLARD	4/21/2020
CHECKED KPINHEIRO	4/21/2020
ENGINEER JPOLLARD	4/21/2020



**RADIAN HEATSINKS**  
RADIAN THERMAL PRODUCTS, INC.  
2160 WALSH AVE  
SANTA CLARA, CA 95050

47.5 MM BGA FANSINK

SIZE	DWG. NO.	REV.
A	FB47.5	A

SHEET 1 OF 1