

THE INFORMATION CONTAINED IN THIS DRAWING IS THE SOLE PROPERTY OF RADIAN HEATSINKS AND ANY REPRODUCTION IN PART OR IN WHOLE IS STRICTLY PROHIBITED WITHOUT THE WRITTEN PERMISSION OF RADIAN HEATSINKS.

REV	DESCRIPTION	APPROVED	DATE
A	INITIAL RELEASE	KP	4/16/2023

EXPLODED VIEW

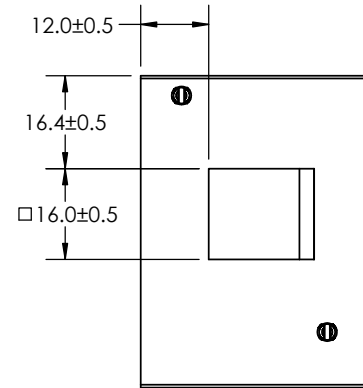
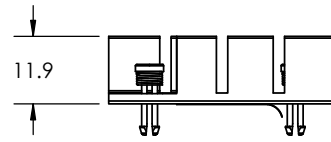
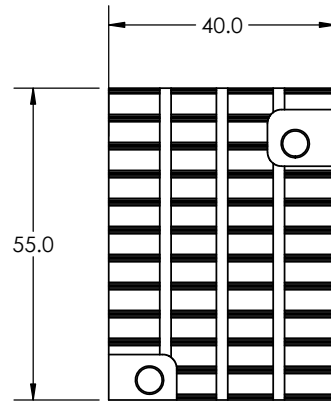
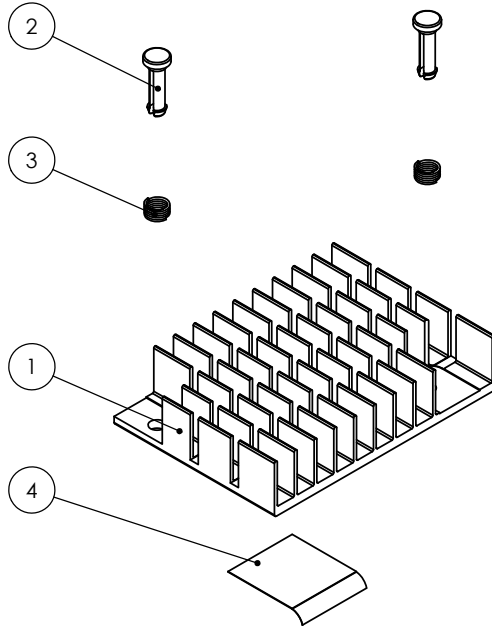

NOTES: (UNLESS OTHERWISE SPECIFIED)
1. PART SHALL BE RoHS COMPLIANT

ITEM NO.	PART NUMBER	DESCRIPTION	QTY.
1	PC11152	CROSS CUT PLATE FIN HEAT SINK	1
2	HS8175	BRASS PUSH PIN	2
3	SP029	COMPRESSION SPRING	2
4	P9909	CHOMERICS T725 PAD 16X16mm WITH RELEASE LINER	1

UNLESS OTHERWISE SPECIFIED
DIMENSIONS ARE IN mm
TOLERANCES ARE:
1 PLACE DECIMALS: ± 0.25
2 PLACE DECIMALS: ± 0.10
ANGLES: ± 1°

THIRD ANGLE PROJECTION

APPROVALS	DATE
DRAWN LCAPILI	04/04/2023
CHECKED CTOLENTINO ENGINEER	04/12/2023
KPINHEIRO	04/04/2023



RADIAN HEATSINKS
RADIAN THERMAL PRODUCTS, INC.
2160 WALSH AVE
SANTA CLARA, CA 95050

HEAT SINK ASSEMBLY

SIZE	DWG. NO.	REV.
A	PC11153	A

SHEET 1 OF 1

THE INFORMATION CONTAINED IN THIS DRAWING IS THE SOLE PROPERTY OF RADIAN HEATSINKS AND ANY REPRODUCTION IN PART OR IN WHOLE IS STRICTLY PROHIBITED WITHOUT THE WRITTEN PERMISSION OF RADIAN HEATSINKS.

REV	DESCRIPTION	APPROVED	DATE
A	INITIAL RELEASE	KP	4/16/2023

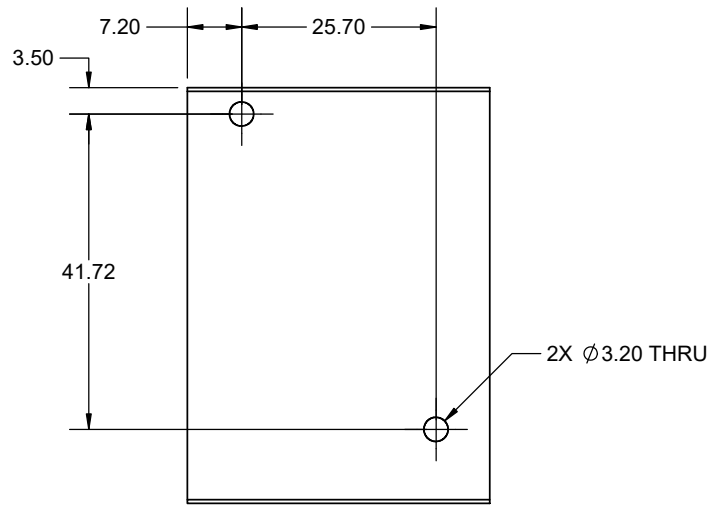
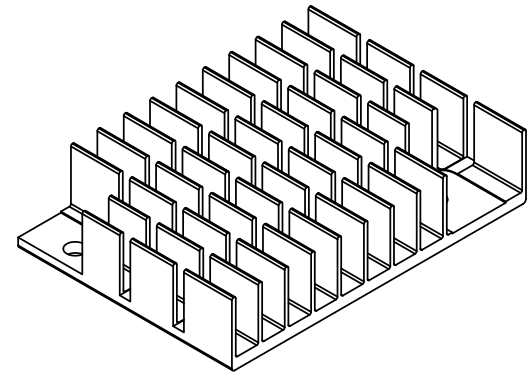
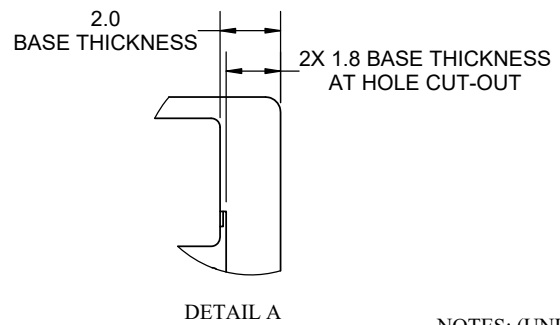
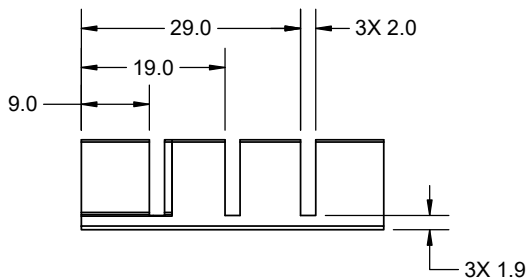
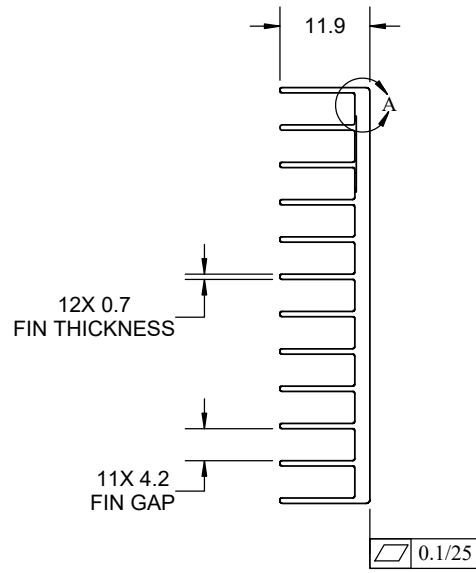
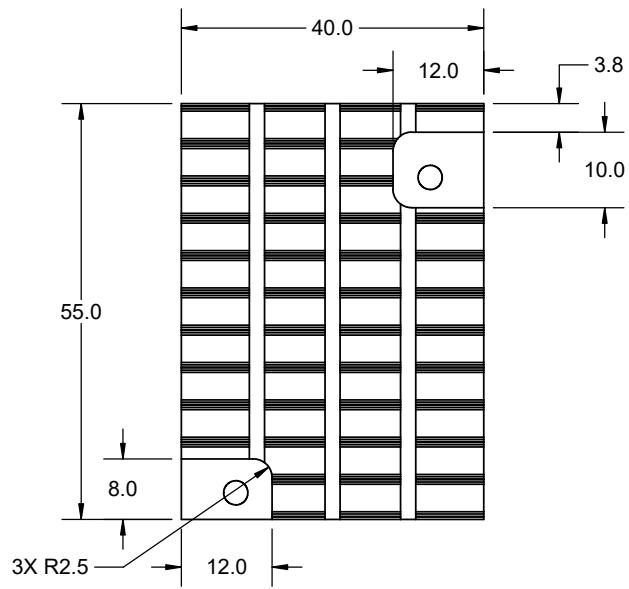

NOTES: (UNLESS OTHERWISE SPECIFIED)

- 1 MATERIAL: AL6061/AL6063
- 2 PART CAN BE MADE FROM EMU153 OR EMU096 EXTRUSION
- 3 FINISH: ANODIZE PER MIL-A-8625 TYII CL2 BLACK
- 4. MAX. RADIUS 0.35 mm IS ALLOWED AT FIN TIPS AND ROOTS
- 5. MAX DRAFT ANGLE 0.5° IS ALLOWED
- 6. PART SHALL BE FREE OF BURRS AND SHARP EDGES
- 7. PART SHALL BE RoHS COMPLIANT

MATERIAL	1 2	APPROVALS	DATE
DRAWN		LCAPILI	04/05/2023
FINISH	3	CHECKED	
UNLESS OTHERWISE SPECIFIED DIMENSIONS ARE IN mm TOLERANCES ARE: 1 PLACE DECIMALS: ± 0.25 2 PLACE DECIMALS: ± 0.10 ANGLES: ± 1°		CTOLENTINO	04/12/2023
		ENGINEER	
		KPINHEIRO	04/05/2023
THIRD ANGLE PROJECTION		SHEET 1 OF 1	

 RADIAN HEATSINKS RADIAN THERMAL PRODUCTS, INC. 2160 WALSH AVE SANTA CLARA, CA 95050	CUSTOM HEATSINK	
	SIZE DWG. NO.	REV.
A	PCI1152	A