

THE INFORMATION CONTAINED IN THIS DRAWING IS THE SOLE PROPERTY OF RADIAN HEATSINKS AND ANY REPRODUCTION IN PART OR IN WHOLE IS STRICTLY PROHIBITED WITHOUT THE WRITTEN PERMISSION OF RADIAN HEATSINKS.

REV	DESCRIPTION OF REVISIONS	APPROVED	DATE
A	INITIAL RELEASE	TSIN	07/19/10

EXPLODED VIEW

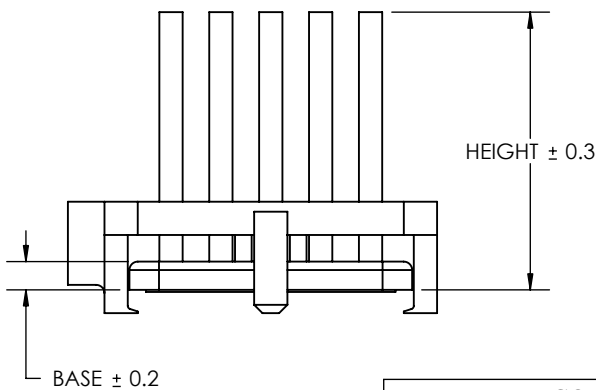
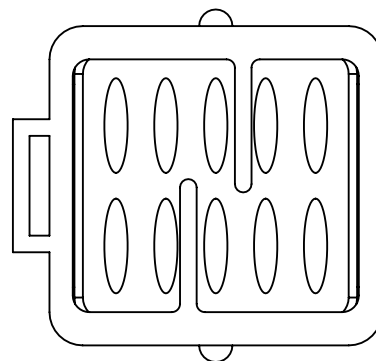
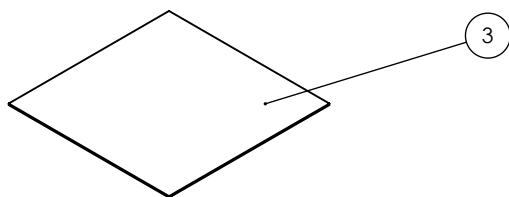
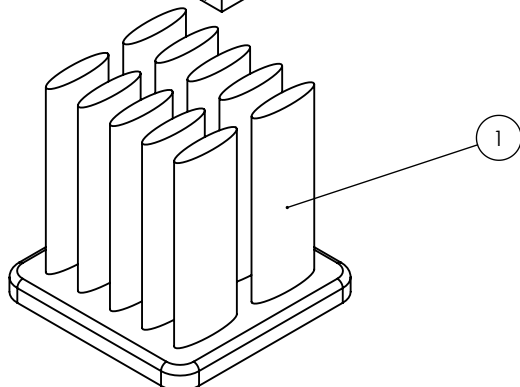
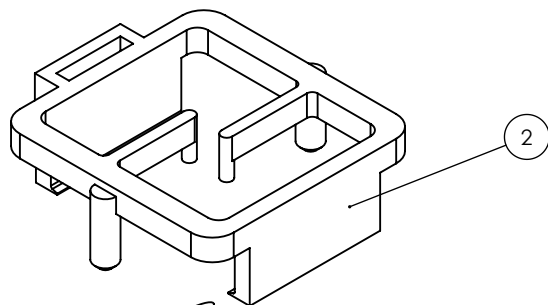

- NOTES:
 1. SEE TABLE BELOW FOR COMPLETE PART NUMBER WITH OPTIONS.
 2. RECOMMENDED KEEP-OUT AREA: 23X21 MM.
 3. COLOR OF CLIP TO BE SELECTED BASED ON CHIP HEIGHT AS ILLUSTRATED BELOW.

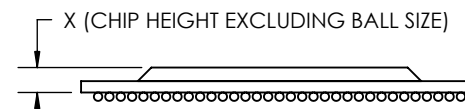

X	CLIP COLOR
2.1 - 2.6 MM	YELLOW
1.5 - 2.0 MM	BLUE
0.9 - 1.4 MM	ORANGE

COMPLETE PART NUMBER WITH OPTIONS

ROOT	HEIGHT (hh)	BASE	CLIP (c)	PAD
INM16001-	11W (11.3 MM)	/2.3 (2.3 MM)	Y (YELLOW)	+T710
	14W (14.3 MM)			
	17W (17.3 MM)		BU (BLUE)	+OTHER
	20W (20.3 MM)			
	22W (22.3 MM)			
	27W (27.3 MM)			
32W (32.3 MM)				

EXAMPLE PART NUMBER: INM16001-22W/2.3BU+T710

ITEM NO.	PART NUMBER	DESCRIPTION	QTY.
1	INM16001-hhW/2.3	ELLIPTICAL HEAT SINK (SEE TABLE ON THE RIGHT FOR HEIGHT CODE hh)	1
2	BCP1918-07(16)c	16 MM BGA CLIP (SEE TABLE ON THE RIGHT FOR CLIP CODE c)	1
3	OPTIONAL	THERMAL PAD 14X14 MM FOR FULL COVERAGE OF HEATSINK BASE	1

MATERIAL	APPROVALS	DATE
FINISH	DRAWN	FWANG 07/19/10
UNLESS OTHERWISE SPECIFIED DIMENSIONS ARE IN MM TOLERANCES ARE: 1 PLACE DECIMALS: ± 0.3 2 PLACE DECIMALS: ± 0.2 ANGLES: ± 1°	CHECKED	TLAM 07/19/10
	MFG ENG	
	QUAL ENG.	
	THIRD ANGLE PROJECTION	

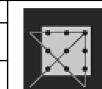

RADIAN HEATSINKS
 DIV. OF INTRICAST CO. INC.
 2160 WALSH AVE
 SANTA CLARA, CA 95050

16MM ELLIPTICAL HEAT SINK ASSEMBLY

SIZE	DWG. NO.	REV.
A	INM16001	A

SHEET 1 OF 1